



ORGANIZE IT ALL.

PLEASE READ INSTRUCTIONS COMPLETELY BEFORE ASSEMBLY

For assistance or missing parts in the USA, please email customerservice@kennedy-intl.com or call **Monday thru Friday (732) 654-2770**
All international (outside USA) customers who have missing, defective or damaged parts must contact the retailer directly to make an exchange or return for refund. All other customer service product and/or questions may be directed to us (in English).

Style: NH-16916 W

#	①	②	③	④	⑤	⑥	⑦	⑧	Template
P A R T S									
QTY	1	1	LHX1 RHX 1	2	2	4	4	2	1

Please note: Part#4,5 & 8 has already been attached on to part #3.

In order to avoid missing parts, please do not detach part #4, 5 from part #3 until step B.

Do not detach part#8 from part #3 until step E."

Caution: when removing part #5 (small screw) from part#3, please secure in safe place while assembling so that it does not get lost.

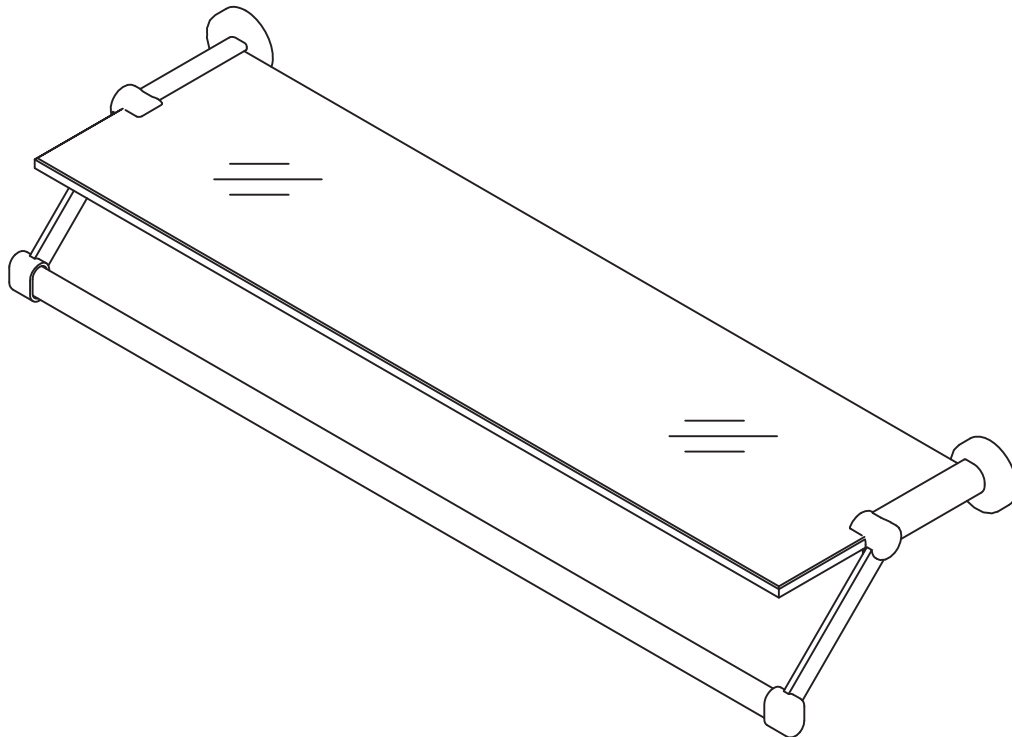

PLEASE NOTE:

We will accept missing parts request with proof of purchase only, within 30 days of purchase.

All return merchandise must be returned directly to the store and not the manufacturer with the proof of purchase.

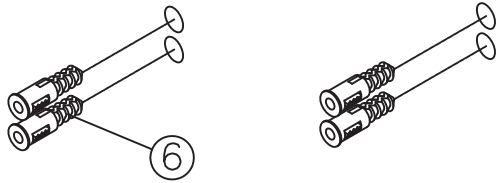
A

Please note: need to pre-drill holes with a 1/4" drill bit before installing wall anchors (part #6) into the wall.
Please look for the paper Mounting Template as guideline.

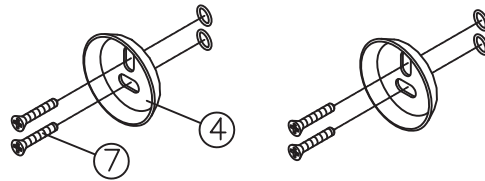
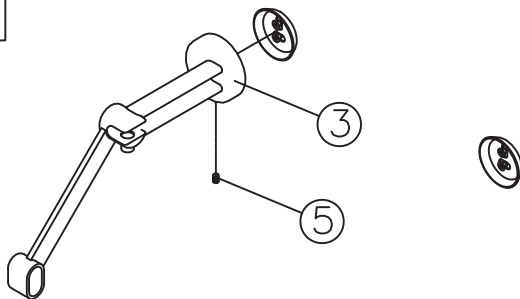
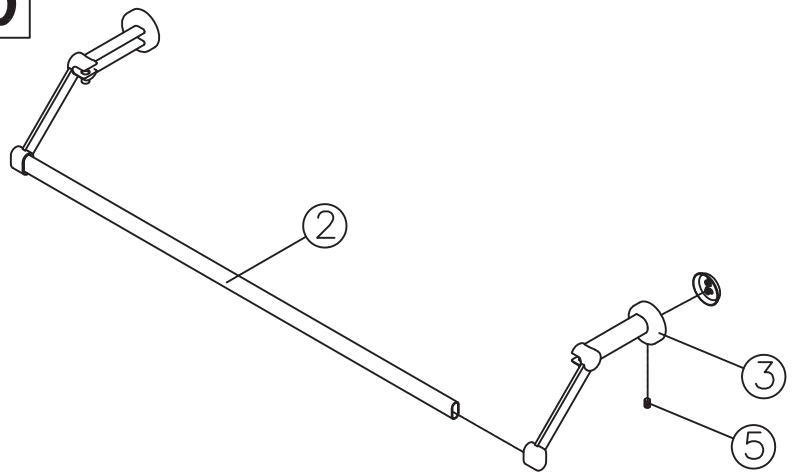
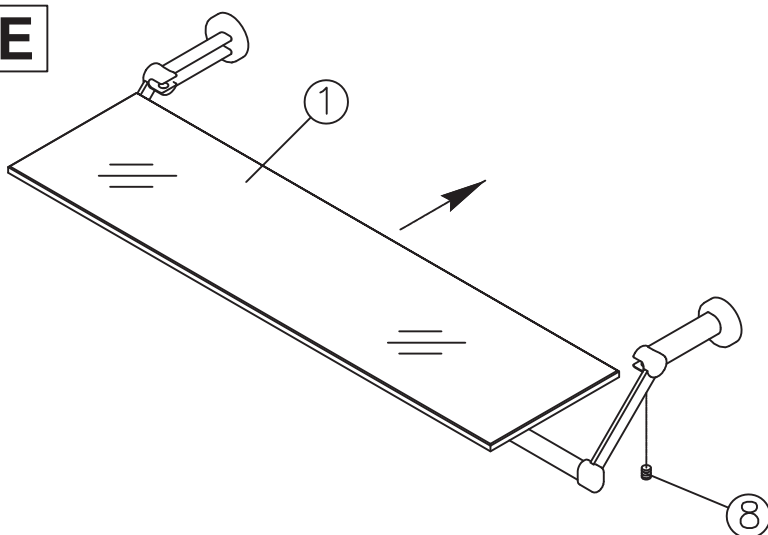
B**C****D****E**

Please note: Part #8 (screw) should be loosened from part #3 (hinges) first before placing the glass shelf on hinges. After glass is settled, part #8 screws may now be tightened.